

STANDARD REINFORCEMENT MESH

NETHERLANDS

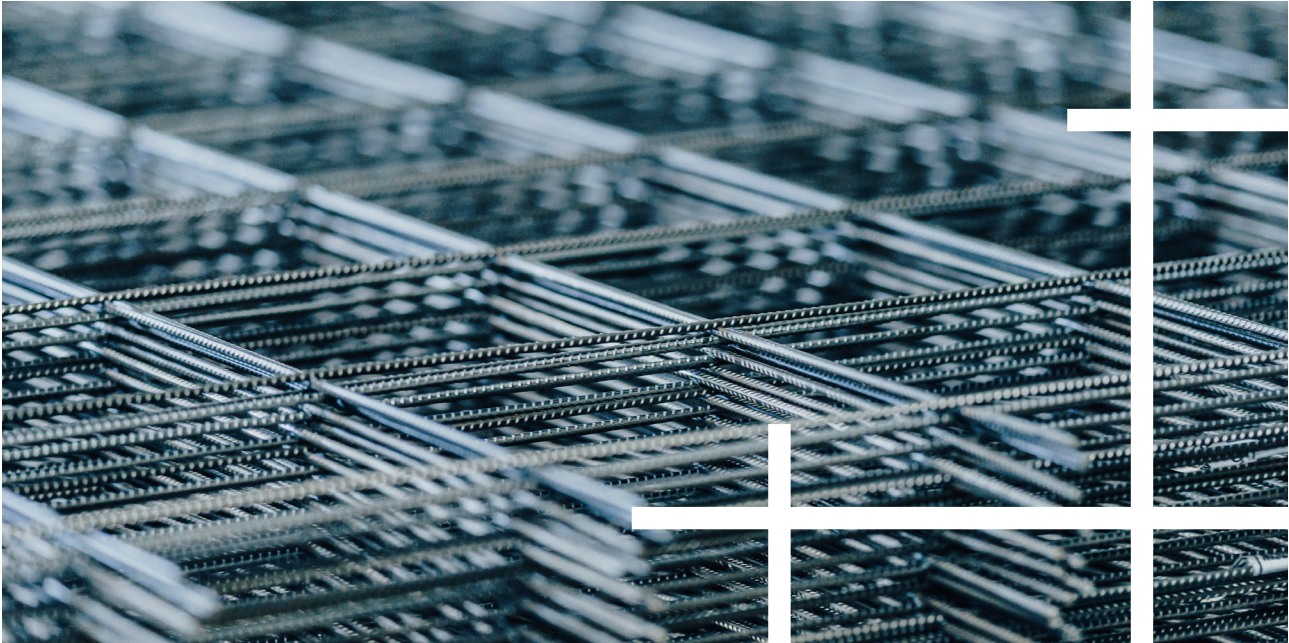

Standard reinforcement mesh is a standardized welded wire mesh, produced in different varieties.

Baustahlgewebe offers standard and special meshes in both grades. Normal ductility meshes made of cold-drawn wire as well as high ductility meshes made of hot-rolled wire with special ribbing.

PRODUCT SPECIFICATION

Grade	» B500A	or	B500B
Ductility	» Normal		High, on request
Fabricated	» According to NEN 6008:2008		
Availability	» B500A from stock or production; B500B on request		

STANDARD REINFORCEMENT MESH

NETHERLANDS

TYPES AND DRAWINGS

Q MESHES AND QS MESHES



Mesh type	Mesh size in m	Wire spacing in mm	Wire ϕ in mm line/cross	Weight per Mesh in kg	Items per bundle	Weight per bundle in kg
Q 188 A	6,00 x 2,30	150/150	6,0/6,0	41,74	50	2.087,00
Q 257 A	6,00 x 2,30	150/150	7,0/7,0	56,78	40	2.271,00
Q 335 A	6,00 x 2,30	150/150	8,0/8,0	74,26	30	2.228,00
Q 424 A	6,00 x 2,30	150/150	9,0/9,0	84,36	30	2.531,00
Q 524 A	6,00 x 2,30	150/150	10,0/10,0	100,88	20	2.018,00
Q 636 A	6,00 x 2,35	100/125	9,0/10,0	132,00	20	2.640,00
QS 130 A	3,00 x 2,00	150/150	5,0/5,0	12,63	50	632,00
QS 188 A	3,00 x 2,00	150/150	6,0/6,0	18,20	50	910,00
QS 335 A	3,00 x 2,00	150/150	8,0/8,0	32,39	40	1.296,00

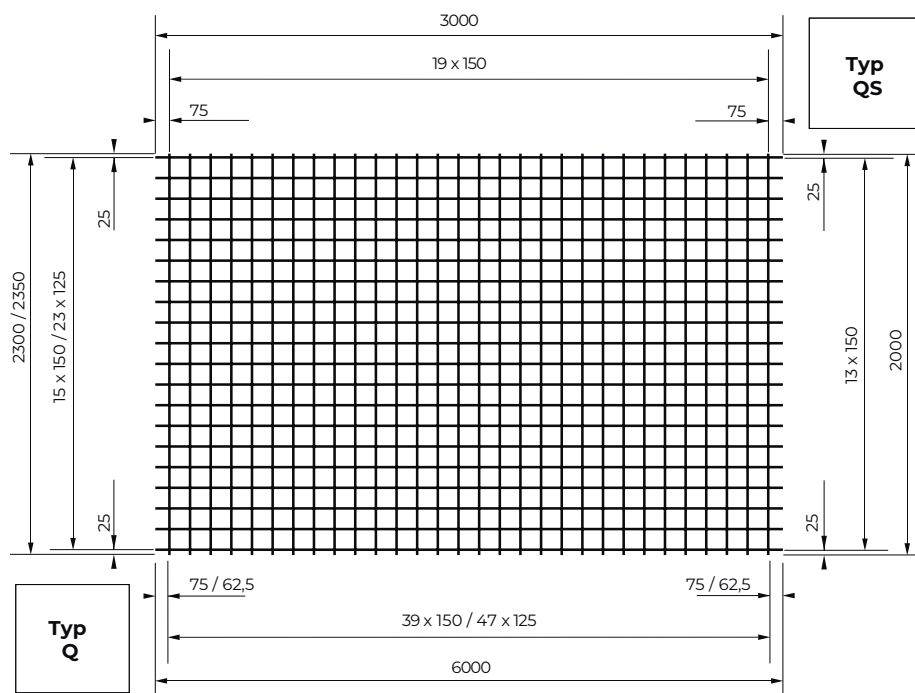

STANDARD REINFORCEMENT MESH

NETHERLANDS

TYPES AND DRAWINGS

B MESHES



Mesh type	Mesh size in m	Wire spacing in mm	Wire \varnothing in mm line/cross	Weight per mesh in kg	Items per bundle	Weight per bundle in kg
B 188 A	5,95 x 2,35	150/150	6,0/6,0	38,32	40	1.533,00
B 335 A	5,95 x 2,35	150/150	8,0/8,0	64,90	20	1.298,00
B 524 A	5,95 x 2,35	150/150	10,0/10,0	101,37	10	1.014,00
B 754 A	5,95 x 2,35	150/150	12,0/12,0	138,53	10	1.385,00
B 503 A	6,00 x 2,40	100/100	8,0/8,0	100,49	10	1.005,00
B 785 A	6,00 x 2,40	100/100	10,0/10,0	156,97	10	1.570,00
B 1131 A	6,00 x 2,40	100/100	12,0/12,0	210,99	5	1.055,00

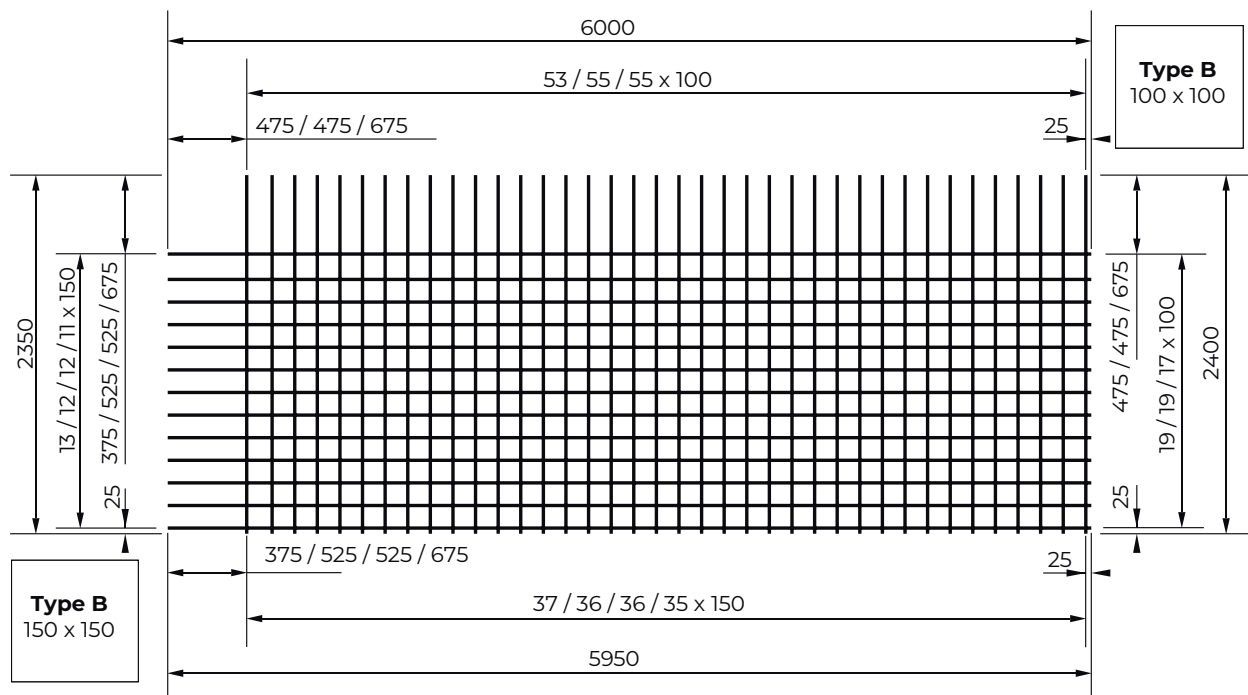

STANDARD REINFORCEMENT MESH

NETHERLANDS

TYPES AND DRAWINGS

BEC MESHES



Mesh type	Mesh size in m	Wire spacing in mm	Wire \varnothing in mm line/cross	Weight per mesh in kg	Items per bundle	Weight per bundle in kg
BEC 188 A	5,95 x 2,35	150/150	6,0/6,0	36,48	40	1.459,00
BEC 257 A	5,96 x 2,36	150/150	7,0/7,0	49,77	30	1.493,00
BEC 335 A	4,45 x 2,35	150/150	8,0/8,0	45,23	30	1.357,00
BEC 524 A	5,90 x 2,30	150/150	10,0/10,0	89,71	15	1.346,00

BEC 188 A

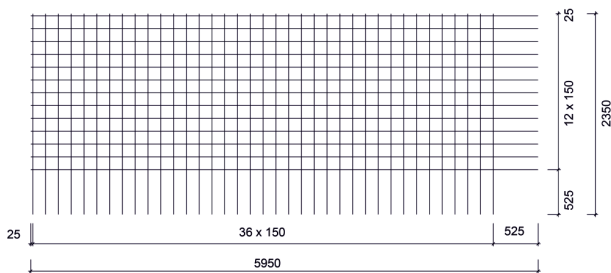

BEC 257 A

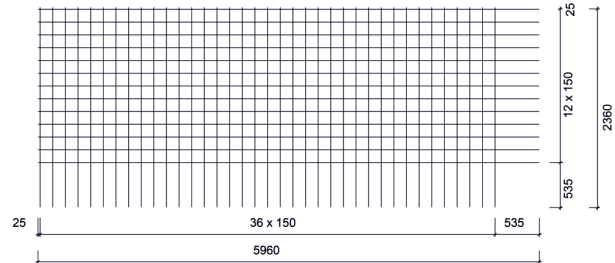

BEC 335 A

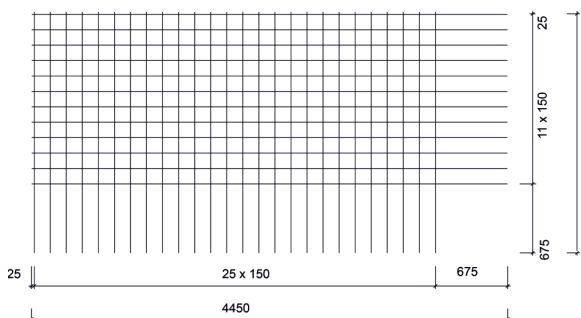

BEC 524 A

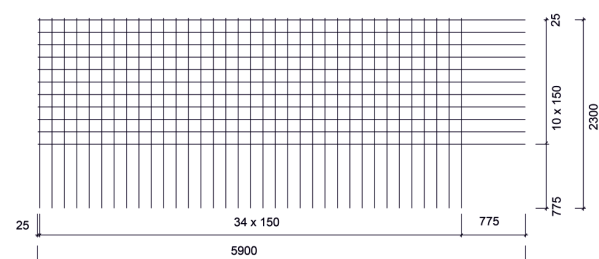

STANDARD REINFORCEMENT MESH

NETHERLANDS

TYPES AND DRAWINGS

P MESHES



Mesh type	Mesh size in m	Wire spacing in mm	Wire \varnothing in mm line/cross	Weight per mesh in kg	Items per bundle	Weight per bundle in kg
P 131	5,00 x 2,00	150/150	5,0/5,0	20,17	50	1.009,00
P 189	5,00 x 2,00	150/150	6,0/6,0	29,08	50	1.454,00
P 335	5,00 x 2,00	150/150	8,0/8,0	51,75	30	1.553,00
P 524	5,00 x 2,00	150/150	10,0/10,0	80,83	20	1.617,00
P 754	5,00 x 2,00	150/150	12,0/12,0	116,33	10	1.163,00

